

Reference

How Do I adjust a John Deere Lawnmower Deck

Checking Mower Deck Level



CAUTION: Avoid injury! Rotating blades are dangerous. Before adjusting or servicing mower:

- Disconnect spark plug wire(s) or battery negative (-) cable to prevent engine from starting accidentally.
- Always wear gloves when handling mower blades or working near blades.

NOTE: Mower deck wheels should not contact the ground when leveling the mower deck.

1. Park machine safely. (See Parking Safely in the SAFETY section.)
2. Inflate tires to the correct pressure.
3. Move mower lift handle to preferred cutting height.
4. Measure mower deck level (side-to-side).

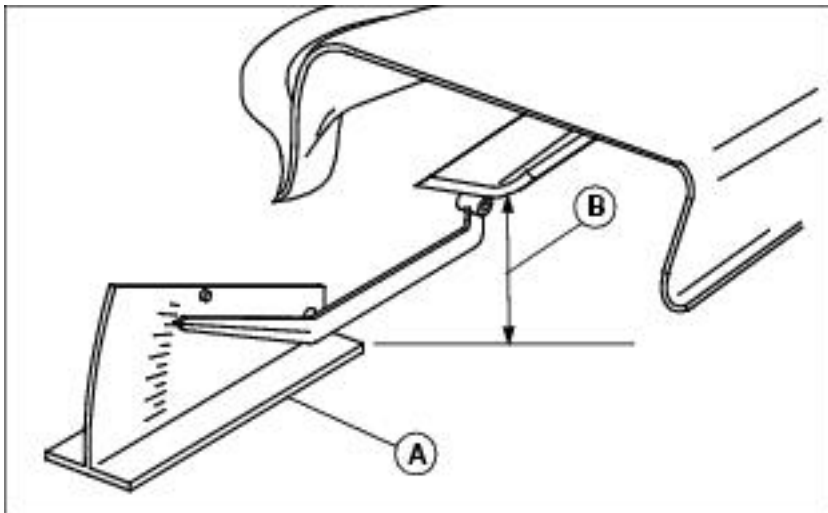

MX4871

Picture Note: A convenient leveling gauge (A) (AM130907) is available from your dealer.

- a. Position mower blades as follows and measure from each outside blade tip (B) to the level

Reference

surface.

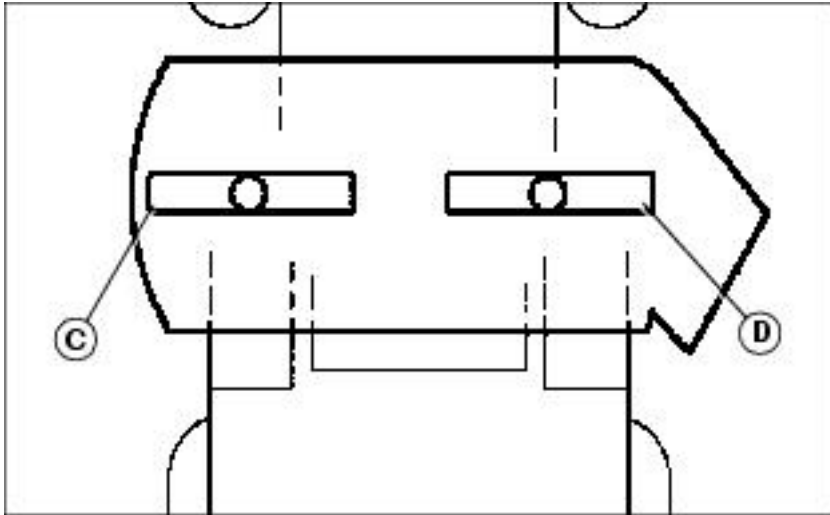

MX4896

b. Turn left blade (C) as shown. Hold drive belt and turn right blade (D) as shown. Take measurement for both blades.

The difference between blade measurements must not be more than 3 mm (1/8 in.).

c. Adjust mower deck level, if necessary.

5. Measure mower level (front-to-rear).

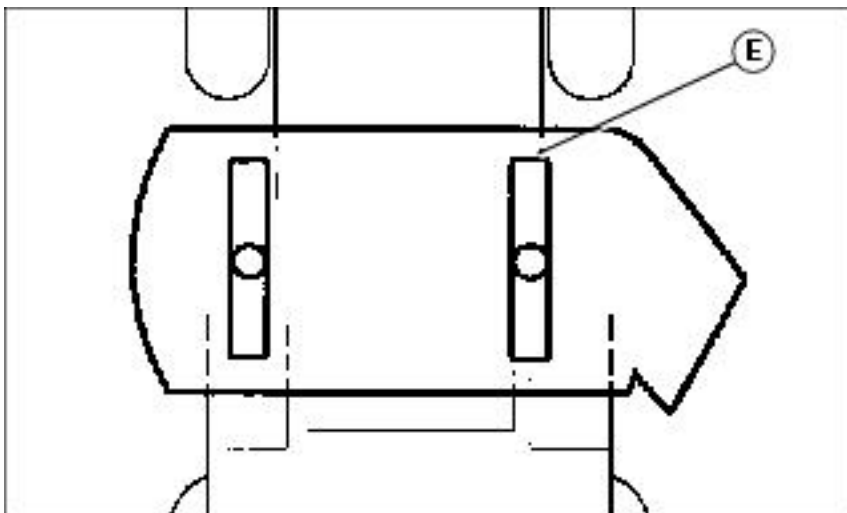

MX4896a

a. Turn right blade (E) so blade tip points straight forward.

b. Measure from blade tip to the surface. Take measurement for both blades.

Reference

The front blade tip must be 3-6 mm (1/8 -1/4 in.) lower than rear blade tip.

c. Adjust mower deck level if necessary.

Adjusting Mower Deck Level

NOTE: Mower deck wheels should not contact the ground when leveling the mower deck.

Method One

1. Make sure machine is on a flat, level surface.
2. Check that tires are inflated to correct tire pressure. Tire pressure is marked on the side of the tire.

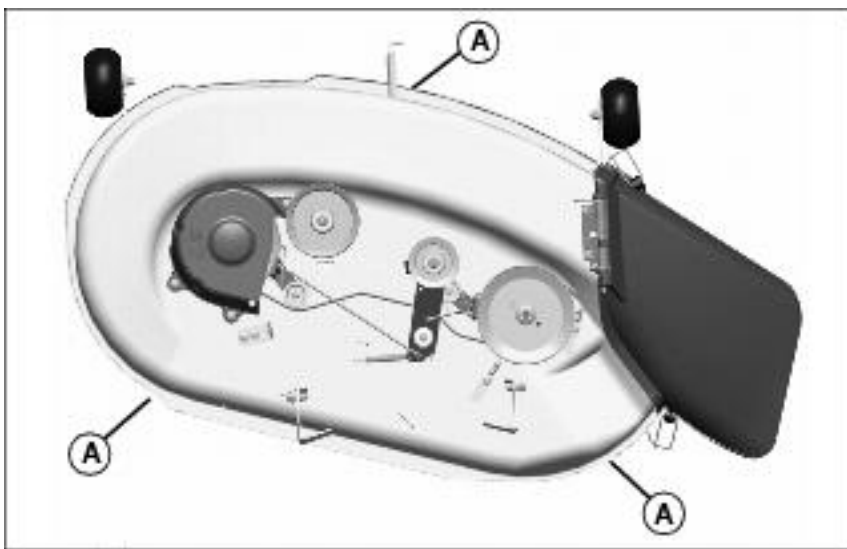

M17687a

Picture Note: 107 cm (42 in.) mower deck shown

3. Place three short 51 mm (2 in.) blocks of wood under the edges (A) of the mower deck.
4. Lower mower deck to the 65 mm (2.5 in.) cutting height position.
5. Check that the mower deck is level and lightly touching each of the three wooden blocks.

Reference

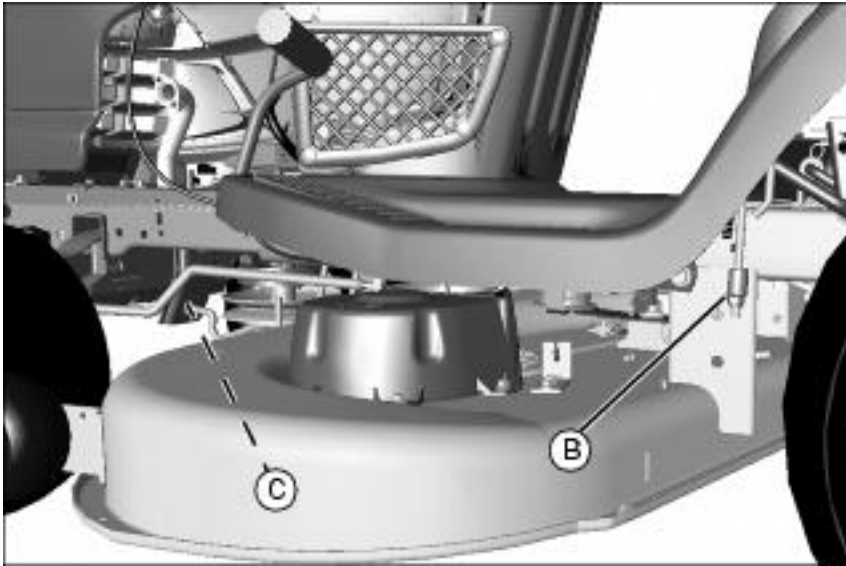

MX16561

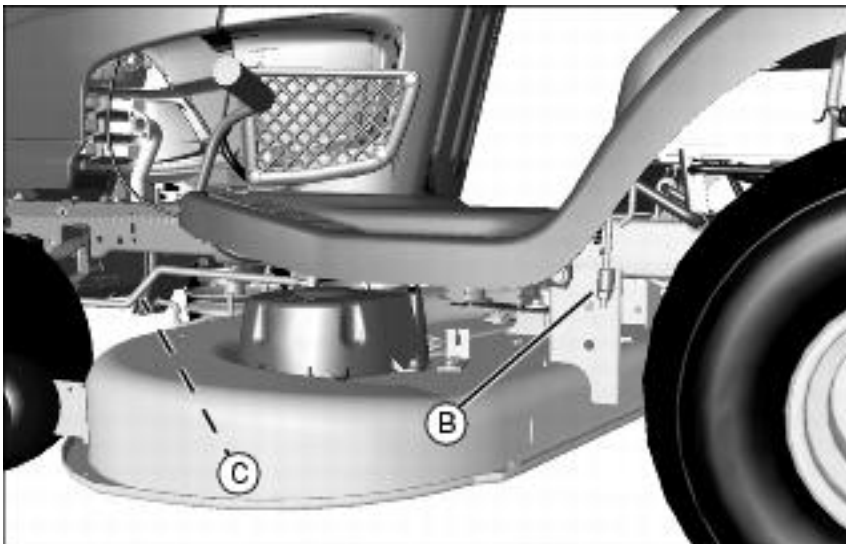

MX16561

· If the rear of the mower deck is not touching the rear blocks, or is sitting heavily on the blocks, adjust the rear lift links by turning the leveling nut (B) on each lift link. The blocks should be able to easily slide in and out beneath the mower deck when the mower deck is correctly adjusted.

Reference

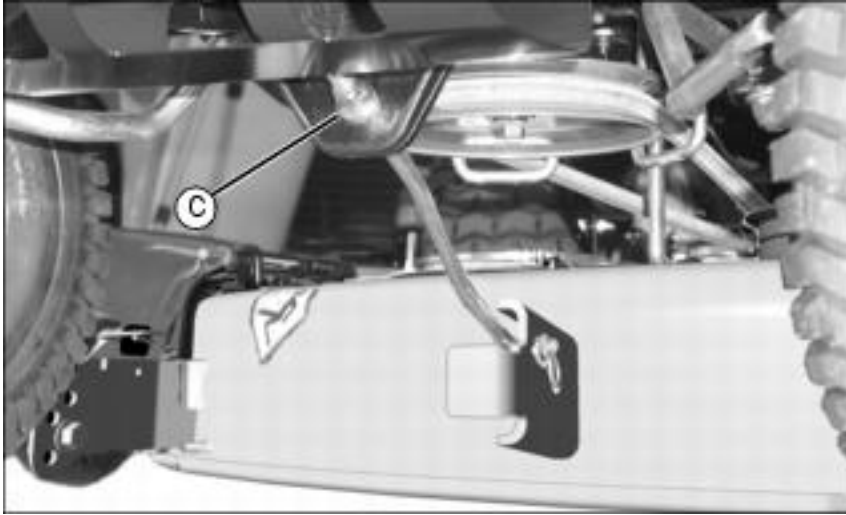

MX10529Y

Picture Note: 107 cm (42 in.) mower deck shown

· If the front of the mower deck is not lightly touching the front block, adjust the front draft arm by turning the nut (C).

6. Raise the cutting height to the next highest position and remove the three wooden blocks.

7. Turn the nut (C) on the front draft arm counterclockwise 1-2 full turns so that the front of the deck is 3-6 mm (1/8-1/4 in.) lower than the rear. This adjustment prevents "double cutting," which wastes horsepower and causes brown grass tips.

Method Two

1. Make sure machine is on a flat, level surface.

2. Check that tires are inflated to correct tire pressure. Tire pressure is marked on the side of the tire.

3. Lower mower deck to the 50 mm (2 in.) cutting height position.

4. With a tape measure or ruler, measure the left rear and right rear edge of the mower deck at points (A). If the two measurements are not equal, turn the leveling nut (B) on each rear lift link to adjust. Repeat procedure until rear corners of the mower deck are level.

5. Measure the front edge of the mower deck directly below the front draft arm hanger at point (A).

· If necessary, turn the front draft arm nut (C) counterclockwise so the front edge of the mower deck is 3-6 mm (1/8-1/4 in.) lower than the rear corners of the mower deck.

NOTE: An optional mower deck leveling gauge (AM130907) is available from your John Deere

Reference

dealer. It allows for precision mower deck leveling by measuring mower deck level at the blade tips.

Adjusting Mower Deck Wheels

IMPORTANT: Avoid damage! The mower deck can be damaged if mower wheels are adjusted wrong:

- Wheels must not ride on ground supporting mower weight.
- Check wheel adjustment each time cutting height is changed.

1. Park machine safely. (See Parking Safely in the SAFETY section.)
2. Inflate tires to the correct pressure.
3. Lower mower deck to the desired mowing position.

NOTE: Bottom of wheels should be approximately 3-13 mm (1/8-1/2 in.) from the ground.

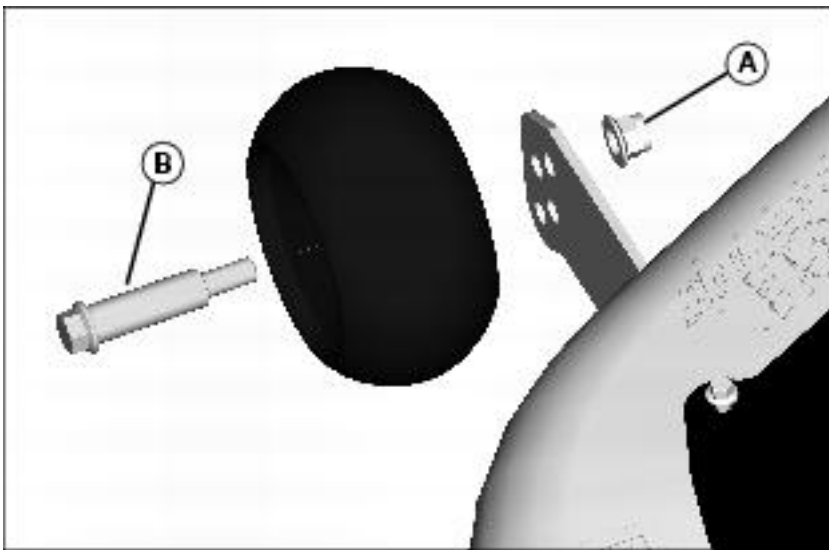

MX10509a

4. Check each mower wheel position. Remove nut (A) and bolt (B), and move mower wheel to proper hole.

Reference

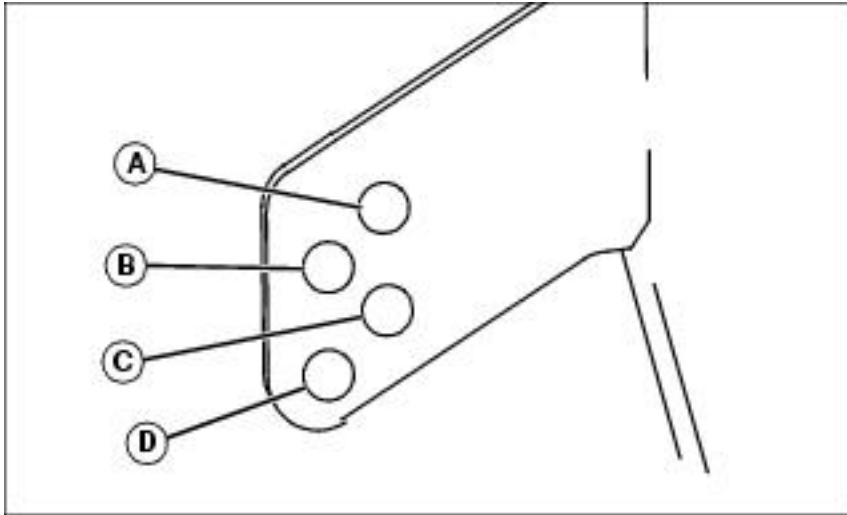

MIF

A - 38 mm (1.5-In.)

B - 51 mm (2-In.)

C - 64 mm (2.5-In.)

D - 76 mm (3-In.) and above

5. Install bolts and nuts to lock wheels in position. Tighten nuts to 34 N·m (25 lb-ft).

Unique solution ID: #1017

Author: Kelly

Last update: 2013-05-23 17:55